

Safety Switch

341-BT GuardSwitch

Applications

- Requiring Highly Defeat Resistant Switches
- Meets ANSI, Semi S2 & European Safety Standard for the Highest Machine Risk Category 4 when used with the INT Safety Relay
- Washdown Environments
- Packaging Machinery
- Pharmaceutical Equipment
- Semiconductor Equipment
- Food Processing Machinery

General Specifications

| | |
|-------------------------------------|--|
| Enclosure | Kynar® Polyvinylidene Flouride with sonic welded lid |
| Temperature Range | 14°F to 150°F (-10°C to 65°C) |
| Environmental | Hermetically Sealed Contact Switch Encapsulated in Polyurethane |
| NEMA Rating | 1, 2, 4, 4X, 5, 12, 12K, 13 |
| Protection Class | IP 67 |
| Response Time (individual circuits) | 1 msec The two circuits do not switch simultaneously and depend on the speed of the guard closure. A delay less than 50 msec is typical. |
| Life Cycles | 100,000 Under Full Load; Up to 200,000,000 Under Dry Circuit |
| Lead Types/O.D. | 18/4 SJTOW (K) / 0.34" (0.86cm) 22/4 PVC Jacketed (J) / 0.19" (0.48cm) 22/6 PVC Jacketed (J) / 0.21" (0.53cm) |
| UL/CSA/TUV | All Models |

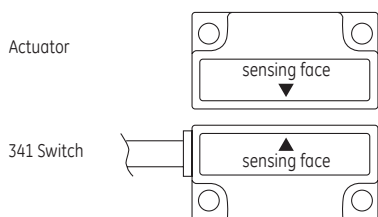
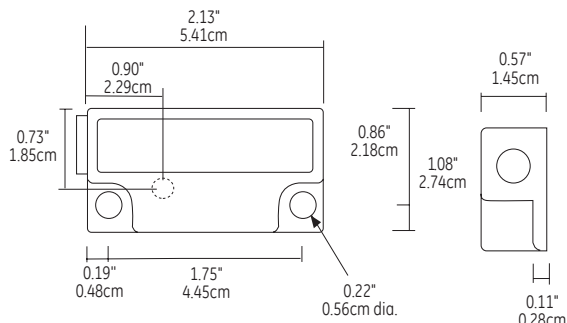

U9880128199005
When used with INT
Safety Monitor Relay



Electrical Specifications (Applies to all models)

| Circuit No. | Circuit Type | Contact Configuration | Load Rating | MAX Switching Voltage | MAX Switching Current |
|-------------|----------------|-----------------------|-------------|-----------------------|-----------------------|
| 1 | Switch | N.O. | 10W/VA | 48VAC/VDC | 0.2A |
| 2 | Tamper | N.C. | 10W/VA | 48VAC/VDC | 0.2A |
| 2 | w/optional LED | N.C. | 0.1-1.4W | 48VDC(3V drop) | 30mA |
| 3 | Monitor | N.O. | 10W/VA | 48VAC/VDC | 0.2A |

Order Information

| Part Number | Contact ¹ Configuration | Sense Range ² Minimum | Sense Range ² Maximum | Break ² Range | Lead Length |
|-------------------|------------------------------------|----------------------------------|----------------------------------|--------------------------|-------------|
| 341-BT-06K | DPST: 1 N.O., 1 N.C. | 0.12"(0.3cm) | 0.38"(1.0cm) | 0.75"(1.9cm) | 6' (1.8m) |
| 341-BT-12(J)OR(K) | DPST: 1 N.O., 1 N.C. | 0.12"(0.3cm) | 0.38"(1.0cm) | 0.75"(1.9cm) | 12' (3.6m) |
| 341-BLT-12K | DPST: 1 N.O., 1 N.C. w/ LED | 0.12"(0.3cm) | 0.38"(1.0cm) | 0.75"(1.9cm) | 12' (3.6m) |
| 341-B3T-12J | TPST: 2 N.O., 1 N.C. | 0.12"(0.3cm) | 0.38"(1.0cm) | 0.75"(1.9cm) | 12' (3.6m) |
| 341-B3LT-12J | TPST: 2 N.O., 1 N.C. w/LED | 0.12"(0.3cm) | 0.38"(1.0cm) | 0.75"(1.9cm) | 12' (3.6m) |

Warning— Each electrical rating is an individual maximum and cannot be exceeded!

¹ Configuration with actuator away from the switch

² Proximity of ferrous materials usually reduces sense range — typically by 50%. The shape and type of material cause a wide diversity of effects. Testing is required to determine actual sense range for specific applications.

